

HOA2-1.6L-GPS-GSM/1670

Hemi Omni Antenna

Provisional Specification

The most important thing we build is trust.

Designed for Thuraya Satallite Network

Integrated GPS and Tri-band GSM antenna

Hemi omni RF coverage

Suitable for mobile applications

Suitable for integration with Thuraya FDU

Provisional performance patterns available.

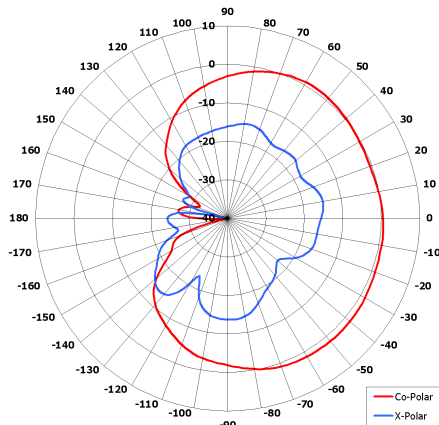

SAT Elevation Polar Plot (similar product)

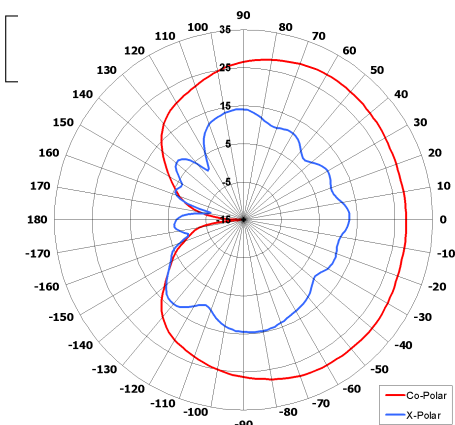

GPS Elevation Polar Plot (similar product)

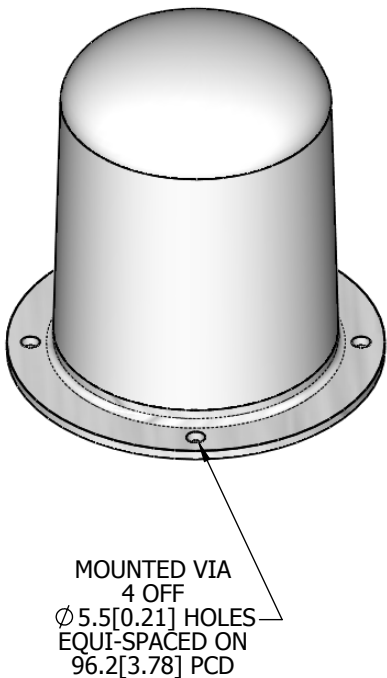
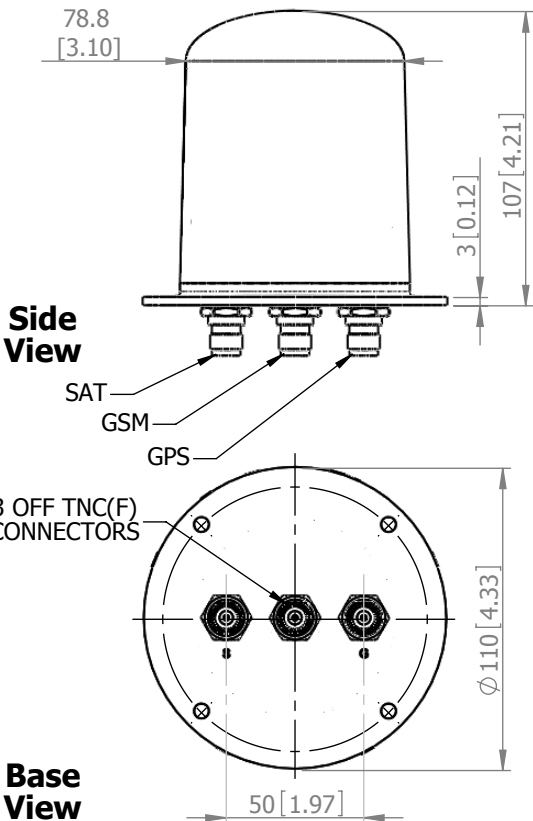

ELECTRICAL (SAT)

Frequency:	1.525 - 1.6605 GHz
Gain:	2 - 4 dBiC Nom.
Polarisation:	Left Hand Circular
Beamwidth:	360° (Az) x 163° (El)
Axial Ratio:	2.5 dB Typ.
VSWR:	2:1
Power Rating:	20 W
Front to Back:	N/A

MECHANICAL

Standard Finish:	Alocrom Base, White Plastic Radome
Mass:	225 g / 0.495 lbs
Temperature:	-40° to +70°C
Wind Loading:	1.34 Kg / 2.96 lbs @ 100 mph
Integral GPS:	+30 dBiC Gain, 5 V DC via coax
Integral GSM:	Covers 880 - 2175 MHz

MOUNTING OPTIONS

Kits Available:	TBA
See Separate Data Sheets	

GA: 1670-A	Issued: 010609
Dimensions: mm [inches]	H

European Antennas Limited trading as Cobham Antenna Systems, Microwave Antennas

European Antennas Limited has a policy of continuous development and stress that the information provided is a guide only and does not constitute an offer or contract or part thereof. Whilst every effort is made to ensure the accuracy of the information contained in this Data Sheet, no responsibility can be accepted for any errors or omissions.

The copyright of antenna designs and images is copyright protected and owned by European Antennas Limited.
©European Antennas Limited.

For further information please contact:

Cobham Antenna Systems, Microwave Antennas

Lambda House, Cheveley,
Newmarket, Suffolk. CB8 9RG, UK
Tel +44 (0) 1638 732177
Fax +44 (0) 1638 731999
Email antennasystems.ma@cobham.com