

# SECTOR ANTENNA SA9-210-2.4V/1579



## ELECTRICAL

FREQUENCY:	2.0 - 2.7 GHz
GAIN:	9 dBi Nominal
POLARISATION:	Linear (Vertical)
BEAMWIDTH:	210° (Az) x 17° (El) Approx.
CROSS POLAR:	>15 dB Typical
VSWR:	2:1 Maximum
POWER RATING:	50 W
FRONT TO BACK:	10 dB Typical

## MECHANICAL

STANDARD FINISH:	Matt Black
MASS:	1.3 kg / 2.86 lbs
TEMPERATURE:	-40° to +60°C
WIND LOADING:	8.5 kg / 18.8 lbs @ 100 mph

## MOUNTING OPTIONS

KITS AVAILABLE: 154A

See Separate Data Sheets

GA: 1579-1 Issued: 240908  
DIMENSIONS: mm [inches]

**SIDE VIEW**

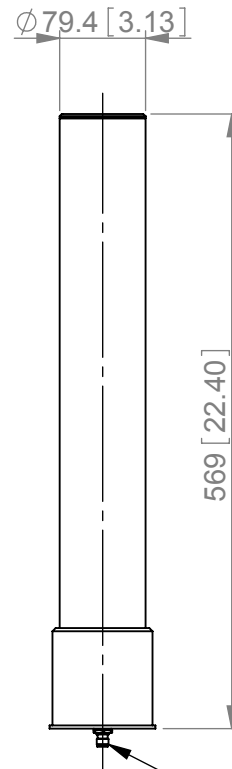

**ISOMETRIC VIEW**



SHOWN WITH OPTIONAL MOUNTING KIT 154A, FOR 2" POLES,

TNC(F) CONNECTOR

**BASE VIEW**

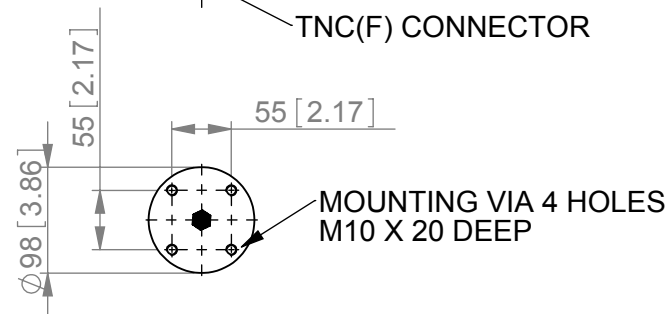

MOUNTING VIA 4 HOLES  
M10 X 20 DEEP

SA9-210-2.4V/1579

European Antennas Ltd. has a policy of continuous development and therefore stress that the data contained on this sheet should be used for guidance only.

European Antennas Ltd. is part of the Cobham Antennas Division



Certificate No 9268

European Antennas Ltd  
Lambda House, Cheveley  
Newmarket, Suffolk, CB8 9RG, UK  
Tel: +44 (0)1638 731888  
sales@european-antennas.co.uk  
[www.european-antennas.co.uk](http://www.european-antennas.co.uk)