



EUROPEAN ANTENNAS

Excellence through design
Creative in concept

RUGGED DIPOLE ANTENNA

MODEL: EVD2-1400-NM/1264

FREQUENCY:	1.35-1.45 GHz	GAIN:	2 dBi
POLARISATION:	Linear (Vertical)	BEAMWIDTH:	360° (Az) x 80° (El)
CROSS POLAR:	20 dB Typical	VSWR:	2:1
POWER RATING:	10 W	MASS:	95g / 0.2lbs
TEMPERATURE:	-20° to +50°C	WIND LOADING:	1.46Kg / 0.66lbs @ 100mph
RADOME:	Glass fibre / Matt Black		

**SIDE
VIEW**

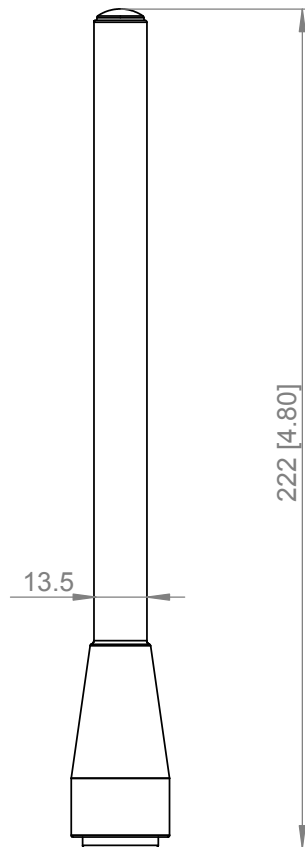

BASE VIEW

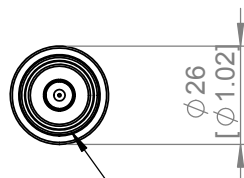

N(M) CONNECTOR

**ISOMETRIC
VIEW**



GA: 1264-2 Issued: 240406 DIMENSIONS: mm (inches) M

EUROPEAN ANTENNAS LTD.
LAMBDA HOUSE, CHEVELEY
NEWMARKET, SUFFOLK, CB8 9RG,
UNITED KINGDOM



Certificate No 9268

Tel: +44 (0)1638 731888
Fax: +44 (0)1638 731999
E-Mail: sales@european-antennas.co.uk
Website: www.european-antennas.co.uk