



EUROPEAN ANTENNAS

Excellence through design
Creative in concept

CONFORMAL ANTENNA

MODEL: WAA1-2355-R/1008

FREQUENCY:	2.355 GHz	GAIN:	-1 dBiC Nominal
POLARISATION:	R. H. Circular	BEAMWIDTH:	360° x 100° Approx.
POWER RATING:	20 W	VSWR:	2 : 1
TEMPERATURE:	-20° to +50°C	MASS:	150 g / 5.3 oz
FINISH:	Natural Material Finish	ATTACHMENT:	Via 14 x M2.5 Screws

TOP VIEW

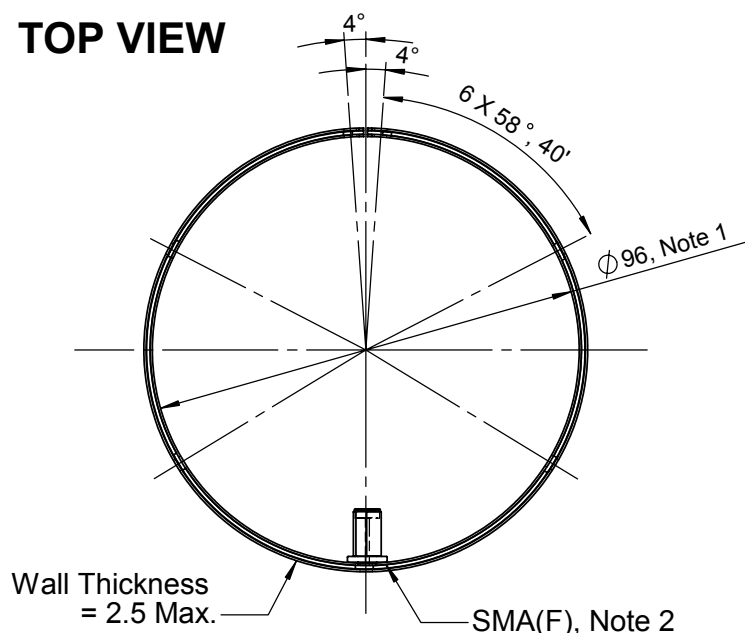

Note 1,
Indicated diameter represents final installed diameter. The product will be sufficiently flexible to be passed over a tube of $\phi 105$ without the connector fouling.

Note 2,
Counterbore a hole of $\phi 10.5$ through to inside of housing with a $\phi 20$ hole, 2 deep to clear solder.

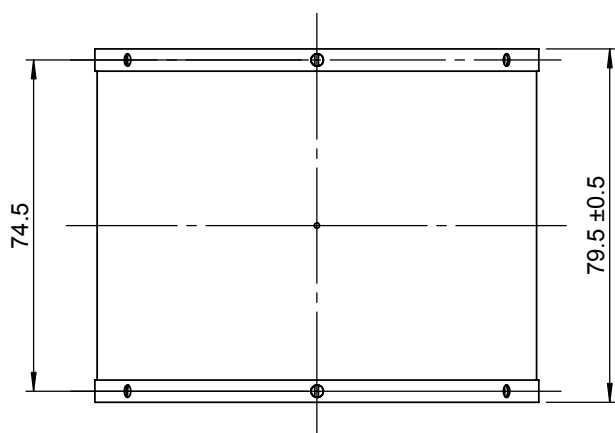

SIDE VIEW

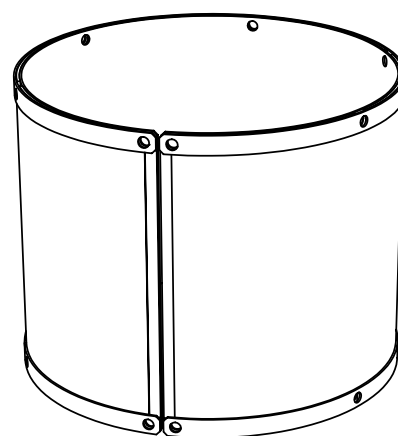

PICTORIAL VIEW

DIMENSIONS: mm (inches)

GA: 1008-1 Issued: 230603

EUROPEAN ANTENNAS LTD.

Tel: +44 (0)1638 731888
Fax: +44 (0)1638 731999

LAMBDA HOUSE, CHEVELEY
NEWMARKET, SUFFOLK, CB8 9RG,
UNITED KINGDOM

E-Mail: sales@european-antennas.co.uk
Website: www.european-antennas.co.uk

European Antennas Ltd. has a policy of continuous development and therefore stress that the data contained on this sheet should be used for guidance only.