



# EUROPEAN ANTENNAS

Excellence through design  
Creative in concept

## CIRCULAR POLARISED ANTENNA

### MODEL: RCO5-2400-MO2-D1/993

<b>FREQUENCY:</b>	2.3 - 2.5 GHz	<b>GAIN:</b>	4 dBiC Nominal
<b>POLARISATION:</b>	R.H. Circular	<b>BEAMWIDTH:</b>	360° (Azimuth) x 60° (Elevation)
<b>AXIAL RATIO:</b>	2 - 3 dB Typical	<b>VSWR:</b>	1.5 : 1
<b>POWER RATING:</b>	30 W	<b>FRONT TO BACK:</b>	N/A
<b>TEMPERATURE:</b>	-20° to +50°C	<b>MASS:</b>	880g / 1.94 lbs
<b>FINISH:</b>	Painted Matt Black	<b>WIND LOADING:</b>	3.77 Kg / 8.28 lbs @ 100 mph

### SIDE VIEW

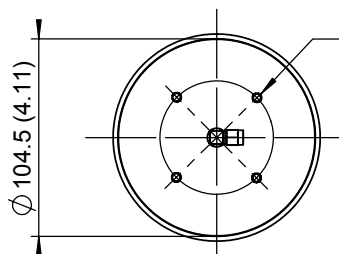
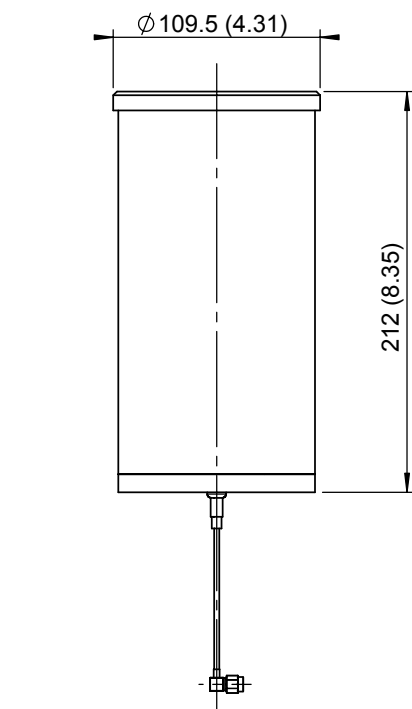

MOUNTING VIA  
4, M5 X 15 HELICOIL INSERTS  
EQUI SP. ON 60.0mm (2.36") PCD

### END VIEW

### PICTORIAL VIEW

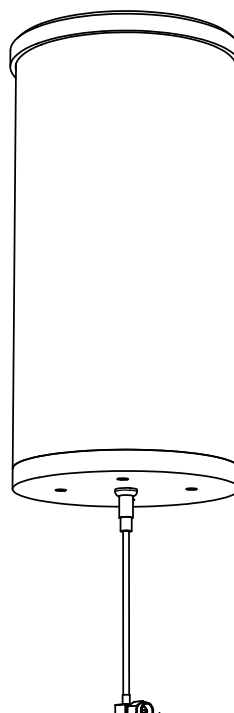

SMA(M) RIGHT ANGLE  
CONNECTOR,  
ON 101.6mm (4") CABLE

**DIMENSIONS:** mm (inches)

GA:993 - 1 Issued:130902

EUROPEAN ANTENNAS LTD.

Tel: +44 (0)1638 731888  
Fax: +44 (0)1638 731999

LAMBDA HOUSE, CHEVELEY  
NEWMARKET, SUFFOLK, CB8 9RG,  
UNITED KINGDOM

E-Mail: [sales@european-antennas.co.uk](mailto:sales@european-antennas.co.uk)  
Website: [www.european-antennas.co.uk](http://www.european-antennas.co.uk)

European Antennas Ltd. has a policy of continuous development and therefore stress that the data contained on this sheet should be used for guidance only.