



EUROPEAN ANTENNAS

Excellence through design
Creative in concept

FLAT PANEL ANTENNA

MODEL: FPA26-28V-ANT/787

CONFORMS TO ETSI EN 300 833 CLASS 1

FREQUENCY:	27.75 - 28.25 GHz	GAIN:	26 dBi Min
POLARISATION:	Linear (Vertical)	BEAMWIDTH:	6° (Az) x 6° (El)
CROSS POLAR:	30 dB	VSWR:	1.5:1
POWER RATING:	5 W	FRONT TO BACK:	40 dB
TEMPERATURE:	-20°C to +50°C	MASS:	560g / 1.23 lbs
FINISH:	Alocrom 1200 & Gloss White Radome	WIND LOADING:	3.85 Kg / 8.46 lbs @ 100 mph

REAR VIEW

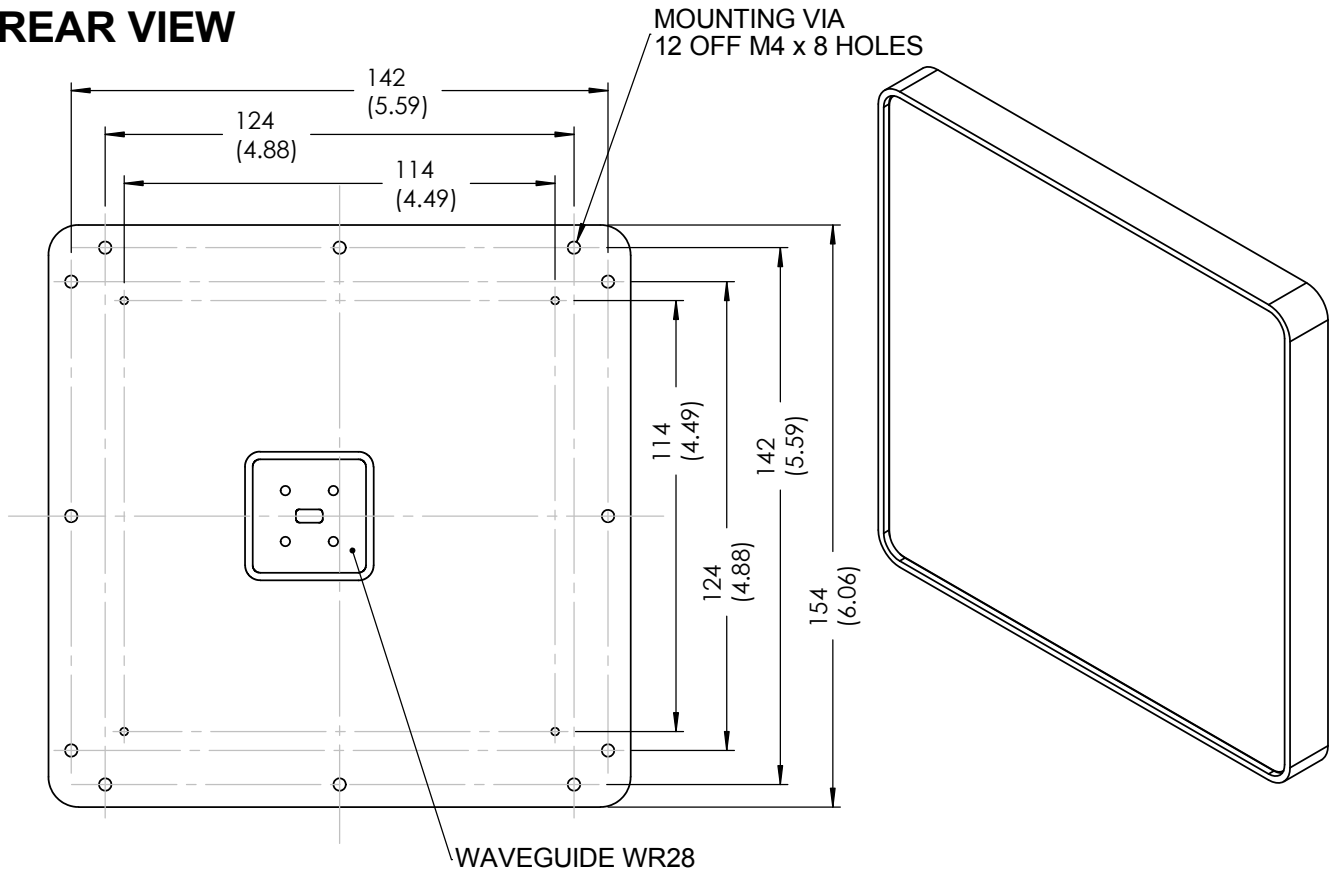

ISOMETRIC VIEW

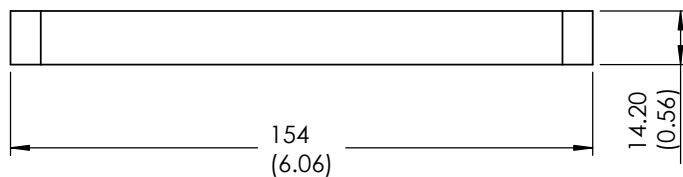

SIDE VIEW

DIMENSIONS: mm (inches)

GA: 0787-1 Issued:191001

EUROPEAN ANTENNAS LTD.

LAMBDA HOUSE, CHEVELEY
NEWMARKET, SUFFOLK, CB8 9RG,
UNITED KINGDOM

Tel: +44 (0)1638 731888
Fax: +44 (0)1638 731999

E-Mail: sales@european-antennas.co.uk
Website: www.european-antennas.co.uk