



EUROPEAN ANTENNAS

Excellence through design
Creative in concept

CIRCULARLY POLARISED OMNI ANTENNA

MODEL: RCO5-58-DT5/884

FREQUENCY:	5.70 - 5.90 GHz	GAIN:	4.7 dBiC Peak
POLARISATION:	R. H. Circular	BEAMWIDTH:	360° (Az) x 33° (El)
AXIAL RATIO:	4 dB Typ.	VSWR:	1.5:1
ELECTRICAL TILT:	5° Down	FRONT TO BACK:	N/A
POWER RATING:	10 W	MASS:	250 g / 0.55 lbs
TEMPERATURE:	-34°C to +52°C	WIND LOADING:	1.64 Kg / 3.6 lbs @ 100 mph
FINISH:	Gloss White		

TOP VIEW

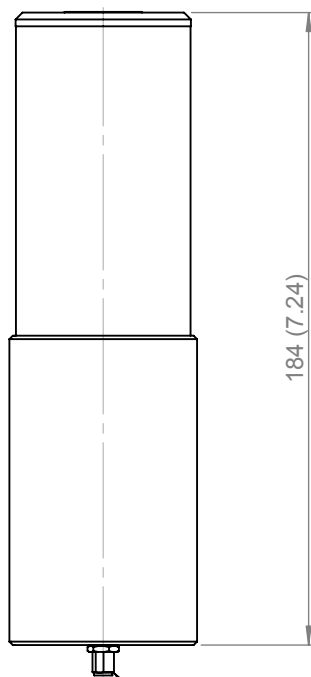
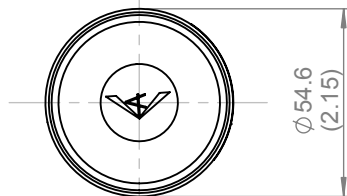

SIDE VIEW

SMA(F) CONNECTOR

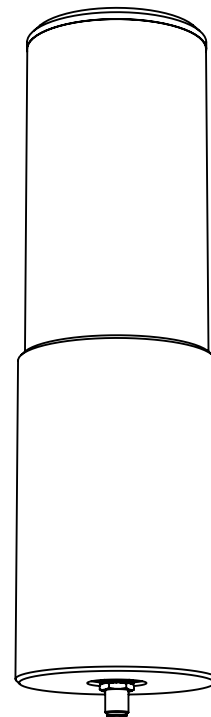

PICTORIAL VIEW

DIMENSIONS: mm (inches)

GA: 884 - 3 Issued: 021107

EUROPEAN ANTENNAS LTD.

LAMBDA HOUSE, CHEVELEY
NEWMARKET, SUFFOLK, CB8 9RG,
UNITED KINGDOM

Tel: +44 (0)1638 731888
Fax: +44 (0)1638 731999

E-Mail: sales@european-antennas.co.uk
Website: www.european-antennas.co.uk