



# EUROPEAN ANTENNAS

Excellence through design  
Creative in concept



## FLAT PANEL ANTENNA

MODEL: SA11 - 18R/665

FREQUENCY:	1.71 - 1.88 GHz	GAIN:	11 dBiC
POLARISATION:	R.H. Circular	BEAMWIDTH:	75° (azimuth) x 25° (elevation)
AXIAL RATIO:	3 dB Typical	VSWR:	1.5:1
POWER RATING:	15 W	FRONT TO BACK:	30 dB
TEMPERATURE:	-20°C to +50°C	MASS:	0.65 kg/1.44 lbs
RADOME:	Grey Moulded Polymer	WIND LOADING:	9.0 kg/19.9 lbs @ 100 mph

### PLAN VIEW

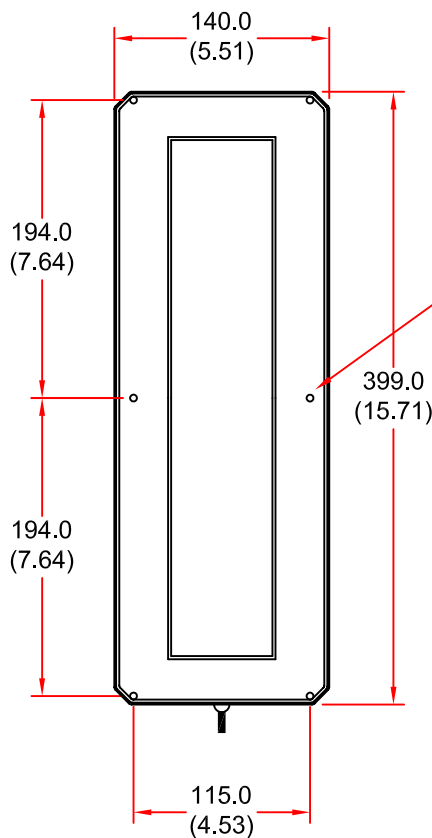

### END VIEW

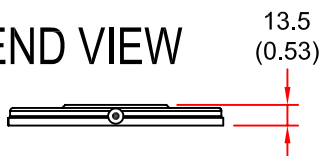

### ISOMETRIC VIEW

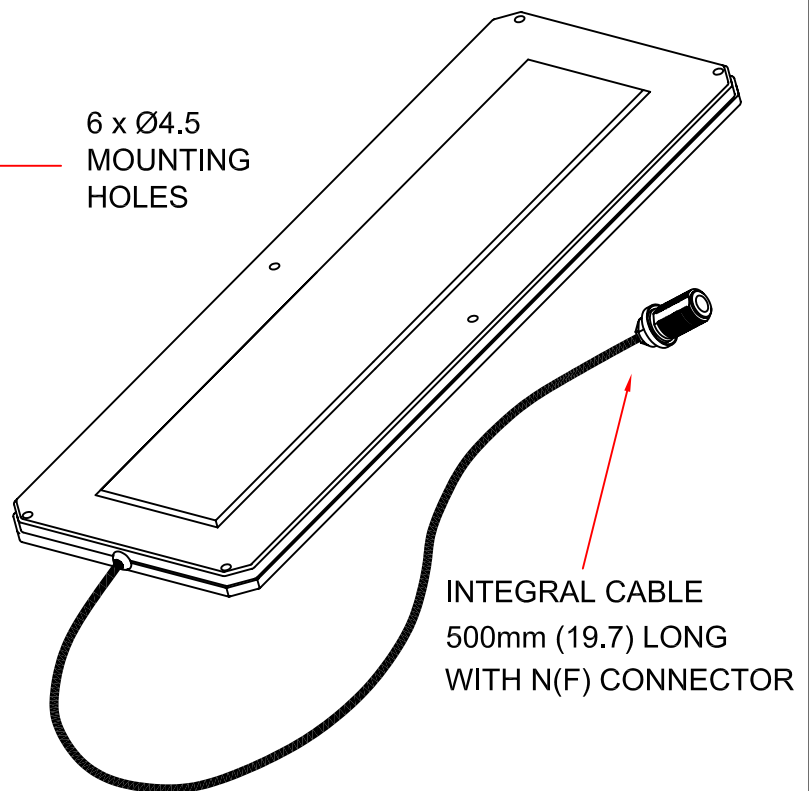

DIMENSIONS: mm (inches)

GA 665-1 Issued 100100

EUROPEAN ANTENNAS LTD.

LAMBDA HOUSE, CHEVELEY,  
NEWMARKET, SUFFOLK, CB8 9RG,  
UNITED KINGDOM.

TEL: +44 (0)1638 731888

FAX: +44 (0)1638 731999

E-Mail: [sales@european-antennas.co.uk](mailto:sales@european-antennas.co.uk)

Website: [www.european-antennas.co.uk](http://www.european-antennas.co.uk)