



# EUROPEAN ANTENNAS



## BROADBAND MATCHING UNIT

MODEL: BMU2-200/596

FREQUENCY: 20 – 500 MHz	VSWR: 2.5 : 1 Max
TEMPERATURE: -20°C to +70°C	MASS: 1.4 Kg/3.1 lbs
POWER RATING: Max 200W continuous when grounded to suitable heatsink	
EFFICIENCY: 3-50% Dependent upon frequency, length of whip antenna & ground plane configuration	
RECOMMENDED WHIP ANTENNA LENGTH: 0.5 to 2.5 M	
FINISH: Weatherproofed in Aluminium Housing (Alocrom 1200 plated)	

PLAN  
VIEW

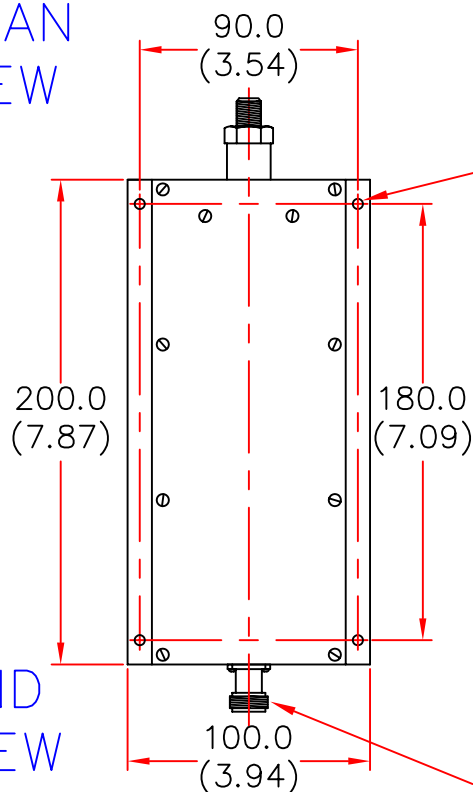

END  
VIEW

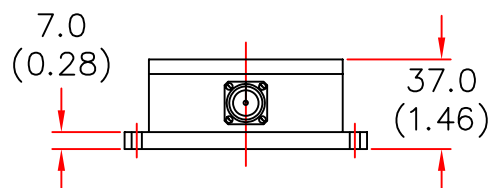

ISOMETRIC VIEW

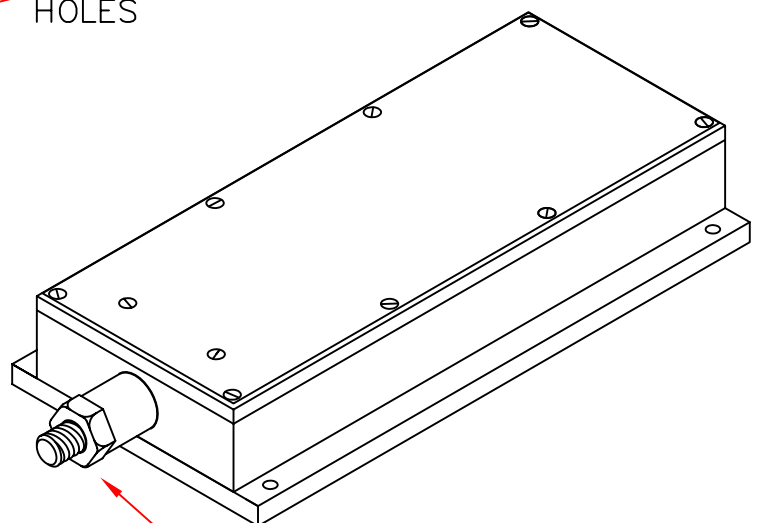

M10 STUD & NUT  
FOR ATTACHING  
WHIP ANTENNA

DIMENSIONS: mm (inches)

GA 596-1 Issued 020999

EUROPEAN ANTENNAS LTD.

TEL: +44 (0)1638 731888

LAMBDA HOUSE, CHEVELEY,  
NEWMARKET, SUFFOLK, CB8 9RG,  
UNITED KINGDOM.

FAX: +44 (0)1638 731999

European Antennas Ltd. has a policy of continuous development and therefore stress that the data contained on this sheet should be used for guidance only.