



EUROPEAN ANTENNAS



SHROUDED YAGI ANTENNA

MODEL: LR14 SD2-13/108

FREQUENCY: 1.24 – 1.34 GHz	GAIN: 14 dBi
POLARISATION: Linear	BEAMWIDTH: 35° x 35°
CROSS POLAR: 20 dB	VSWR: 1.5 : 1
POWER RATING: 5 W	FRONT TO BACK: 19 dB
TEMPERATURE: -25°C to +50°C	MASS: 0.52 Kg/1.14lbs
RADOME: Moulded Grey Polymer	WIND LOADING: 9.0Kg/19.9lbs @100mph

PLAN
VIEW

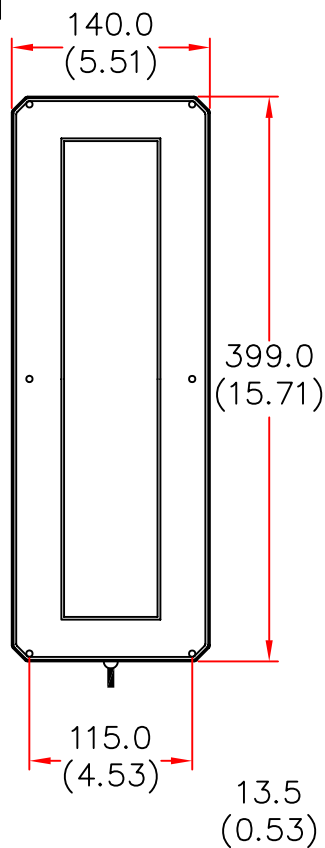

END
VIEW

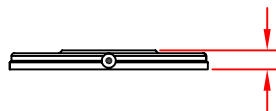

ISOMETRIC VIEW

(SHOWN WITH SUPPLIED
MOUNTING KIT)

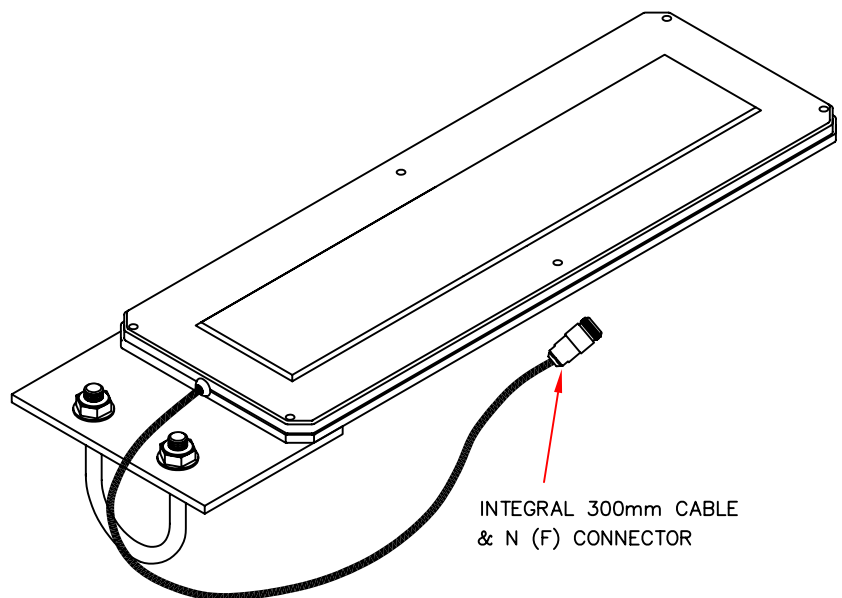

DIMENSIONS: mm (inches)

GA 108-2 Issued 171003

EUROPEAN ANTENNAS LTD.

TEL: +44 (0)1638 731888

LAMBDA HOUSE, CHEVELEY,
NEWMARKET, SUFFOLK, CB8 9RG,
UNITED KINGDOM.

FAX: +44 (0)1638 731999

European Antennas Ltd. has a policy of continuous development and therefore stress that the data contained on this sheet should be used for guidance only.