

DSA10-2.0L-2.4R/2481

Dual Flat Panel Antenna



Key Features

Dual-band 2GHz/2.4GHz

Rugged Enclosure

Circular Polarisation

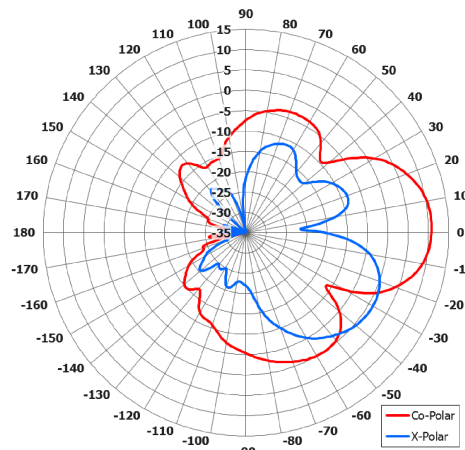

Azimuth Polar Plot

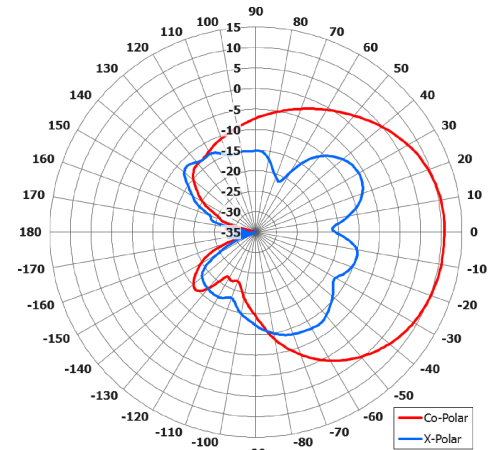

Elevation Polar Plot

SIDE VIEW

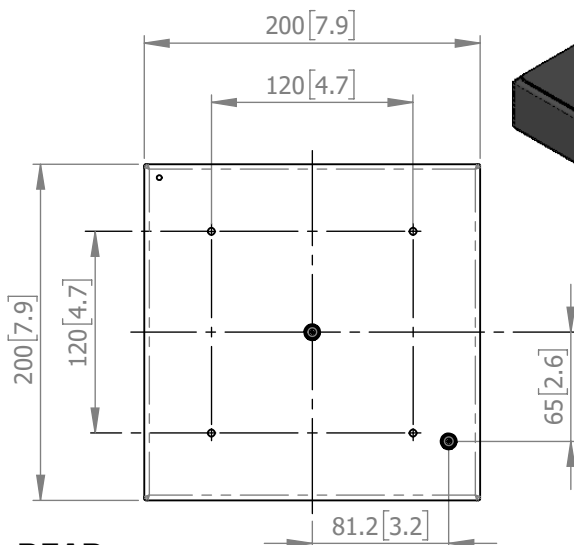
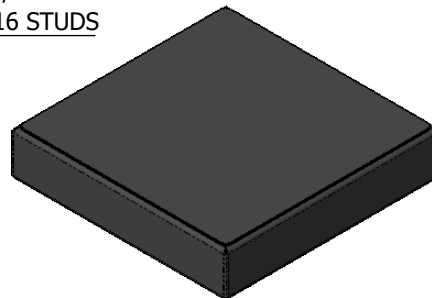
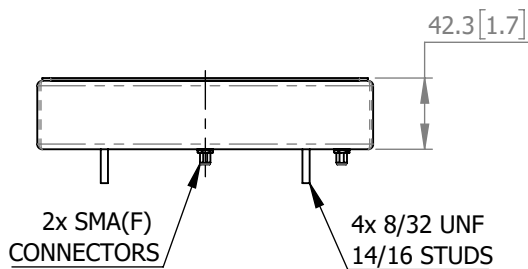

REAR VIEW

ELECTRICAL

	Low Band	High Band
Frequency:	1.92 - 2.17 GHz	2.4 - 2.5 GHz
Gain:	9.15 dBiC Nom.	10.78 dBiC Nom.
Polarisation:	Circular (Left)	Circular (Right)
Beamwidth:	36.5° (Az) x 71° (El)	31.1° (Az) x 67° (El)
Axial Ratio:	2 dB Typ.	2 dB Typ.
VSWR:	>2:1 Max, > 1.5:1 Typ.	
Power Rating:	50 W	
Front to Back:	>20 dB Typ.	>20 dB Typ.

MECHANICAL

Finish:	Black
Mass:	0.78 Kg / 1.72 lbs
Temperature:	-45° to +70°C
Wind Loading:	N/A

MOUNTING OPTIONS

Kits Available: N/A

See Separate Data Sheets

DS: 2481 - 1

Issued: 201118

Dimensions: mm

M

Chelton Limited has a policy of continuous development and stress that the information provided is a guide only and does not constitute an offer or contract or part thereof. Whilst every effort is made to ensure the accuracy of the information contained in this brochure, no responsibility can be accepted for any errors or omissions.

The copyright of antenna designs and images is copyright protected and owned by Chelton Limited.
©Chelton Limited

For further information please contact:

Chelton Limited,
Lambda House, Cheveley,
Newmarket, Suffolk CB8 9RG, UK.

T: +44 (0)1638 732 177

E: newmarket.sales@chelton.com

W: www.chelton.com/microwave